

# ALTA/ACSM LAND TITLE SURVEY

Known as 526-540 Sugar Creek Road, in the City of Delavan, Walworth County, Wisconsin.

Lots 1, 2 and 3 Certified Survey Map No. 534 recorded in the Office of the Register of Deeds for Walworth County, Wisconsin, October 14, 1975 in Volume 2 of Certified Survey Maps page 376, Document No. 697669, being part of the North 1/2 of Section 17, T2N, R16E, City of Delavan Walworth County, Wisconsin situated in the County of Walworth and State of Wisconsin.

Prepared for: Charles Walter

Survey No.5165197-CRW

- A. **Basis of Bearings**  
Bearings are based on the West line of Sugar Creek Road, which is assumed to bear South 00°34'30" East.
- B. **Title Commitment**  
This survey was prepared based on Chicago Title Insurance Company title commitment number 440300, effective date of July 12, 2011, which lists the following easements and/or restrictions from schedule B-II:  
1, 5-8, 12. Visible evidence shown, if any.  
2-4, 9-11, 13. Not survey related.
- C. **Flood Note**  
According to flood insurance rate map of the City of Delavan, community panel number 55127C0169D, effective date of October 2, 2009, this site falls in zone X (areas determined to be outside the 0.2% annual chance floodplain)
- D. **Parking Spaces**  
There are 65 regular and 4 handicapped parking spaces marked on this site.
- E. **Municipal Zoning** Information obtained by surveyor  
The basic zoning information listed below is taken from municipal codes and does not reflect all regulations that may apply - site is zoned RM-12 - Residential Multi Family 12

To: Village Apartments, LLC  
Associated Bank, National Association, its successors and/or assigns  
Chicago Title Insurance Company

This is to certify that this map or plat and the survey on which it is based were made in accordance with the 2011 Minimum Standard Detail Requirements for ALTA/ACSM Land Title Surveys, jointly established and adopted by ALTA and NSPS and includes items 1, 2, 3, 4, 6(a), 7(c), 8, 9, and 11(a) of Table A thereof. The field work was completed on July 22, 2011.

Date of Plat or Map: July 26, 2011

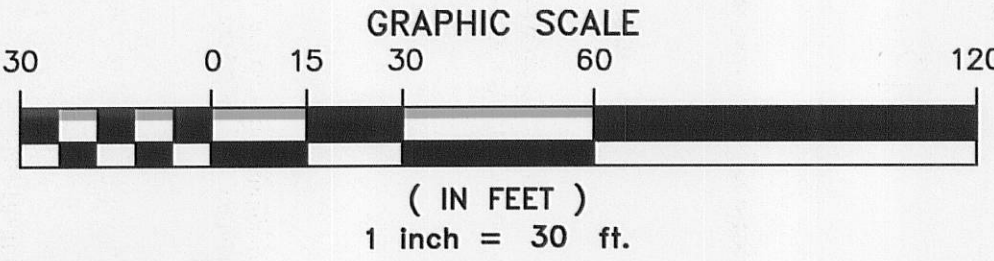
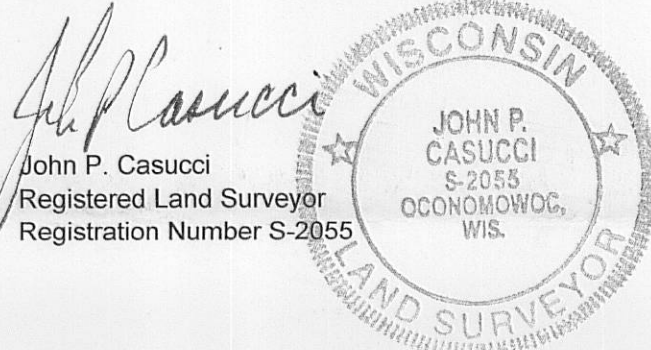

R.A. Smith National, Inc.

Beyond Surveying  
and Engineering

16745 W. Bluemound Road, Brookfield WI 53005-5639  
262-781-1000 Fax 262-797-7373, www.rasmithnational.com  
Appleton, WI Orange County, CA Pittsburgh, PA  
S:\5165197\dwg\ AS101D30.dwg \AS101D30

VICINITY MAP  
NOT TO SCALE

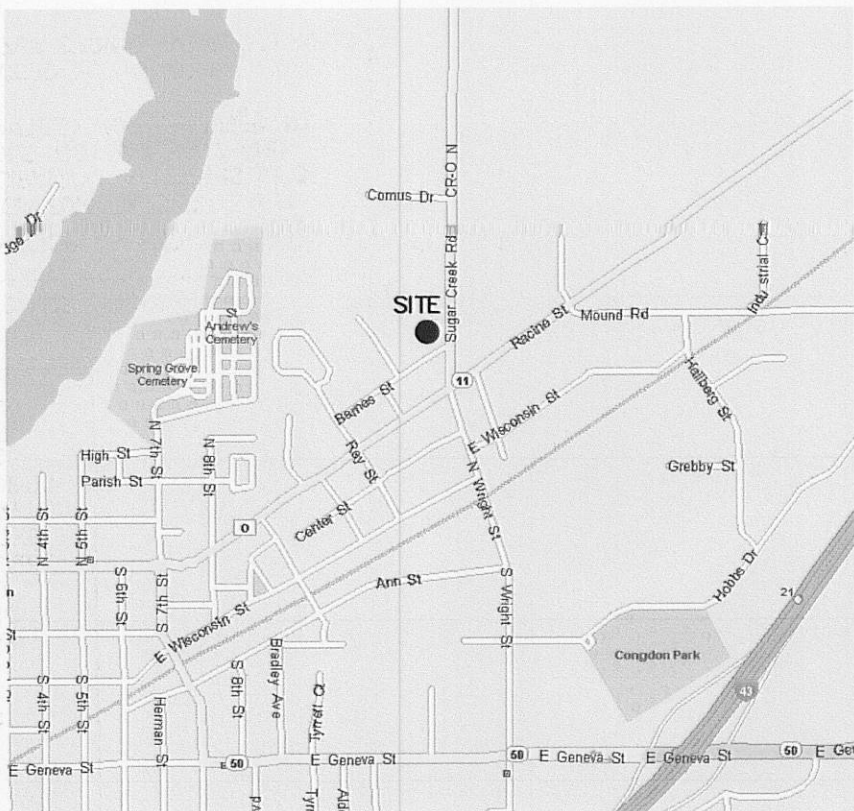

## LEGEND

- ( ) INDICATES RECORDED DIMENSION WHERE DIFFERENT FROM ACTUAL MEASUREMENT
- OR SECTION OR 1/4 SECTION CORNER AS DESCRIBED
- 1" DIA. IRON PIPE FOUND (UNLESS OTHERWISE NOTED)
- 1" DIA. IRON PIPE, 18" LONG-SET (UNLESS OTHERWISE NOTED)
- BOLLARD
- SOIL BORING/MONITORING WELL
- FLAGPOLE
- MAILBOX
- SIGN
- BILLBOARD
- CONTROL BOX
- TRAFFIC SIGNAL
- RAILROAD CROSSING SIGNAL
- CABLE PEDESTAL
- POWER POLE
- GUY WIRE
- LIGHT POLE
- SPOT/YARD/PEDESTAL LIGHT
- HANDICAPPED PARKING
- ELECTRIC MANHOLE
- ELECTRIC PEDESTAL
- ELECTRIC METER
- TELEPHONE MANHOLE
- TELEPHONE PEDESTAL
- MARKED FIBER OPTIC
- GAS VALVE
- GAS METER
- GAS WARNING SIGN
- STORM MANHOLE
- ROUND INLET
- SQUARE INLET
- STORM SEWER END SECTION
- SANITARY MANHOLE
- SANITARY CLEANOUT OR SEPTIC VENT
- SANITARY INTERCEPTOR MANHOLE
- MISCELLANEOUS MANHOLE
- WATER VALVE
- HYDRANT
- WATER SERVICE CURB STOP
- WATER MANHOLE
- WELL
- WATER SURFACE
- WETLANDS FLAG
- MARSH
- CONIFEROUS TREE
- DECIDUOUS TREE
- SHRUB
- EDGE OF TREES
- S-SANITARY SEWER
- STO-STORM SEWER
- W-WATERMAIN
- G-MARKED GAS MAIN
- E-MARKED ELECTRIC
- OHW-OVERHEAD WIRES
- B-BUREAU ELEC. SERV.
- T-MARKED TELEPHONE
- TV-MARKED CABLE TV LINE
- FO-MARKED FIBER OPTIC
- INDICATES EXISTING CONTOUR ELEVATION
- INDICATES EXISTING SPOT ELEVATION

DIGGERS HOTLINE WAS NOT CALLED FOR THIS SITE

THE UNDERGROUND UTILITY INFORMATION AS SHOWN HEREON IS BASED, IN PART, UPON INFORMATION FURNISHED BY UTILITY COMPANIES AND THE LOCAL MUNICIPALITY. WHILE THIS INFORMATION IS BELIEVED TO BE RELIABLE, ITS ACCURACY AND COMPLETENESS CANNOT BE GUARANTEED NOR CERTIFIED TO.

(P) INDICATES PIPE SIZES PER RECORD PLANS. OTHER PIPE SIZES ARE ESTIMATED. NO PIPE SIZES SHOULD BE RELIED UPON WITHOUT FURTHER VERIFICATION.

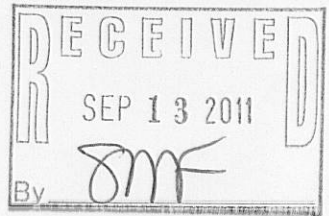

XA 534 1-3

002-2511